



67 Lawrances Road Yea VIC

4 2 4

A property to invest in with potential to subdivide into 5 or 6 blocks of land (STCA). Ideal Superfund Plan or just live the Rural Lifestyle. Within a minute of the Yea Golf Course and High School it's in a great location. The large 55 square Family home under roofline represents 4 Bedrooms plus study, Main bedroom with ensuite & WIR with new carpets. Kitchen/Meals area with extended lounge room with high ceilings wood heating & RCAC to keep the family home comfortable. Step out to the private yard overlooking the Inground swimming pool. Double Carport, Garage 5.5m x 10m & Open Bay Machinery Shed 5m x 5.5m with stable. Beautiful established gardens walking distance to the main street and schools.

Type : House
Price : \$1,200,000-\$1,300,000
Land Size : 2.65 Acres
View : <https://www.nobleknight.com.au/sale/vic/shepparton-central-north/yea/residential/house/8152780>



Anthony Knight
03 5797 2500



Melissa Bell
03 5797 2500

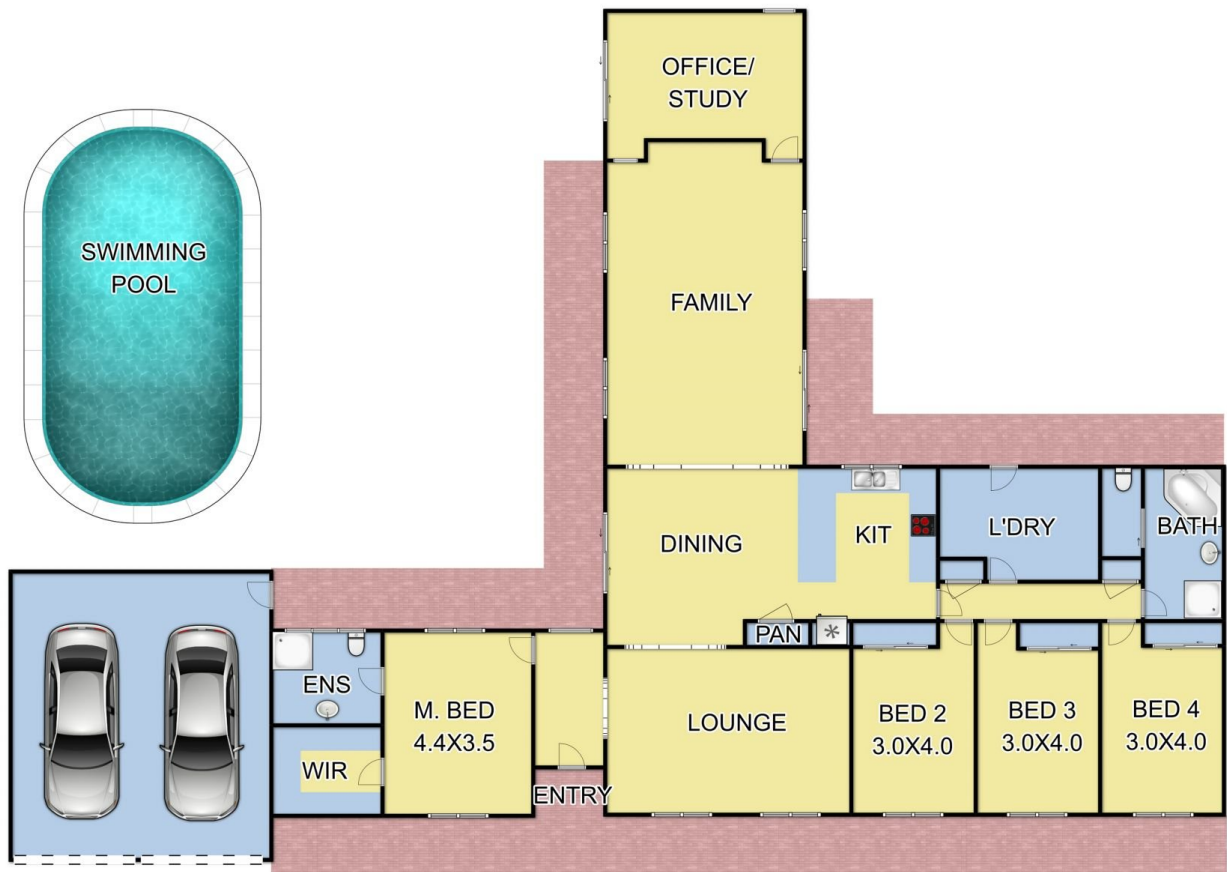

Fixtures & Fittings are for display purposes only. Measurements Approx. Not to Scale.
Produced by Open2view.com.au