



13 Hutchinson Street Lilydale VIC

Presenting an exceptional opportunity in the heart of Lilydale, this strategically positioned property, zoned Commercial 1, holds limitless potential. Its versatility allows for a myriad of possibilities, making it an ideal investment for astute developers and investors alike.

Situated in a prime location sat on 722sqm approx., this property offers the perfect canvas for a mixed-use development encompassing both commercial and residential components. While awaiting planning approvals or finalizing your vision, you have the option to lease out the shop or office space, ensuring a steady income stream by retaining the existing leases for the two factories on the premises.

Boasting an unrivalled central position, the property is strategically located directly across from the renowned

Price : \$ 2,000,000
Building Size : 394 sqm
Land Size : 722 sqm
View : <https://www.nobleknight.com.au/sale/vic/east/lilydale/commercial/other/7746447>



Damian Ford
03 9735 5677



Brad Knight
03 9730 1788

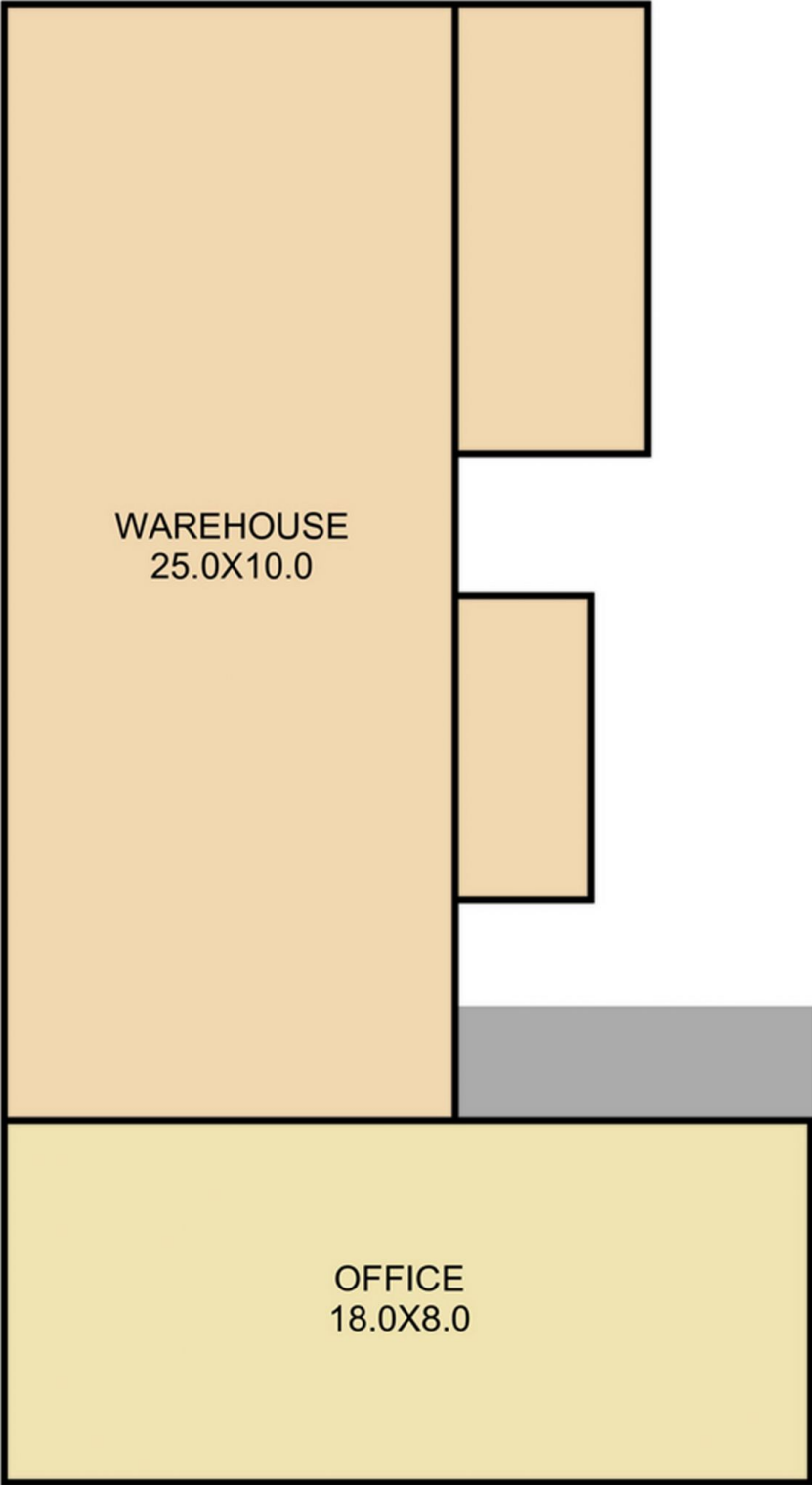

WAREHOUSE
25.0X10.0

OFFICE
18.0X8.0