



### 3 Limestone Road Yea VIC

5 2 4

A rural farmlet on the edge of town awaits a buyer that's looking for a piece of country lifestyle with 7.2 glorious acres. Sealed road and private mains water is an addition to this property with a 5KW solar system back to the grid.

The country style 4/5 bedrooms or study homestead has two bathrooms and has been tastefully renovated with Tasmanian oak timber floors throughout. Wood fire heating, RCAC and open fire place to warm and cool the home. Classic Country kitchen with Manna gum bench tops, gas hotplates & electric oven.

The two living zones compliments the home with family living and formal lounge dining room. The property also features a 1 bedroom studio, open bay shed 4m x 12m and

[For full version visit the website](https://www.nobleknight.com.au)

**Type** : Rural  
**Price** : \$ 1,150,000  
**Land Size** : 7.2 Acres  
**View** : <https://www.nobleknight.com.au/sale/vic/shepparton-central-north/yea/residential/rural/715140>



**Anthony Knight**  
03 5797 2500



**Melissa Bell**  
03 5797 2500

<https://www.nobleknight.com.au>

0397355677



### 3 Limestone Road, Yea 3717

TOTAL APPROX. FLOOR AREA 220 SQ.M

Whilst every attempt has been made to ensure the accuracy of the floor plan contained here, measurements of doors, windows, rooms and any other items are approximate and no responsibility is taken for any error, omission, or misstatement. This plan is for illustrative purposes only and should be used as such by any prospective purchaser.

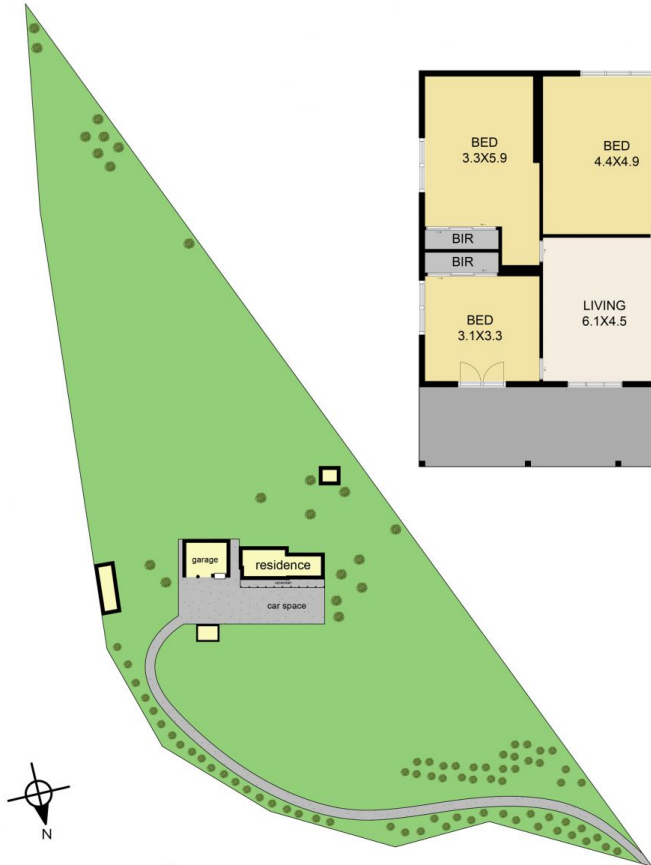

### 3 Limestone Road, Yea 3717

TOTAL APPROX. FLOOR AREA 220 SQ.M

Whilst every attempt has been made to ensure the accuracy of the floor plan contained here, measurements of doors, windows, rooms and any other items are approximate and no responsibility is taken for any error, omission, or misstatement. This plan is for illustrative purposes only and should be used as such by any prospective purchaser.

