



### 8 The Parade Yea VIC

3 1 4

Welcome to "Oakhaven" on the Parade. This character filled 1920's-built home sits pretty in one of Yea's most admired streets on a generous 1259m<sup>2</sup> (approx.) block of land. The floor plan showcases three large, robed bedrooms, cosy living/dining space, central kitchen and bathroom and large covered alfresco area overlooking the garden and stunning Oak tree. The exterior of the property offers drive through tandem carport, 7.5m x 6m shed with concrete floor and power, fernery and under house storage.

The home is heated and cooled by a reverse cycle ducted heating and cooling unit and Coonara and offers an abundance of storage space and endless potential. Located within walking distance to the township, schools and recreation reserve, this home is awaiting a new owner

**Type** : House  
**Land Size** : 1259 sqm  
**View** : <https://www.nobleknight.com.au/sale/vic/shepparton-central-north/yea/residential/house/7587214>



**Anthony Knight**  
03 5797 2500



**Melissa Bell**  
03 5797 2500

[For full version visit the website](https://www.nobleknight.com.au)



**8 The Parade, Yea 3717**

TOTAL APPROX. FLOOR AREA 157 SQ.M

Whilst every attempt has been made to ensure the accuracy of the floor plan contained here, measurements of doors, windows, rooms and any other items are approximate and no responsibility is taken for any error, omission, or misstatement. This plan is for illustrative purposes only and should be used as such by any prospective purchaser.



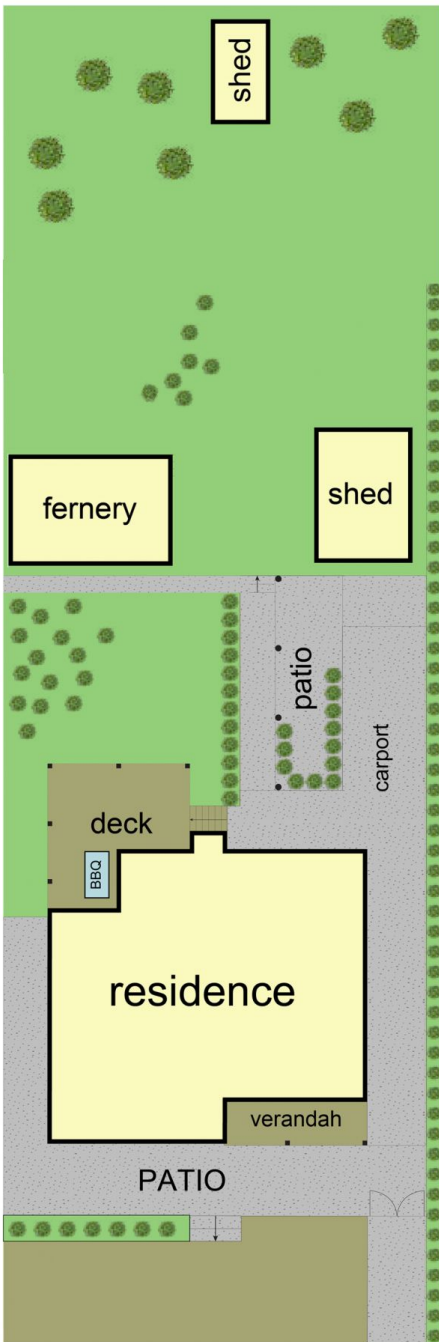

**8 The Parade, Yea 3717**

TOTAL APPROX. FLOOR AREA 157 SQ.M

Whilst every attempt has been made to ensure the accuracy of the floor plan contained here, measurements of doors, windows, rooms and any other items are approximate and no responsibility is taken for any error, omission, or misstatement. This plan is for illustrative purposes only and should be used as such by any prospective purchaser.

