

## 60 Industrial Park Drive Lilydale VIC

Fantastic Commercial Freehold, either Invest or Owner occupier. This allotment is zoned Industrial 1. The site consists of approximately 1660 SQM of land with a 313 SQM approx warehouse and 80 SQM approx office space. The office space is divided into 4 Offices, communal printing area and kitchenette. With 3 phase power available, 3 good access roller doors and a gravel storage yard at the rear. This is an outstanding opportunity for someone looking for an investment or the potential to owner occupy.

**Price** : \$ 1,300,000  
**Building Size** : 393 sqm  
**Land Size** : 1660 sqm  
**View** : <https://www.nobleknight.com.au/sale/vic/east/lilydale/commercial/industrial/6426701>



**Damian Ford**  
**03 9735 5677**

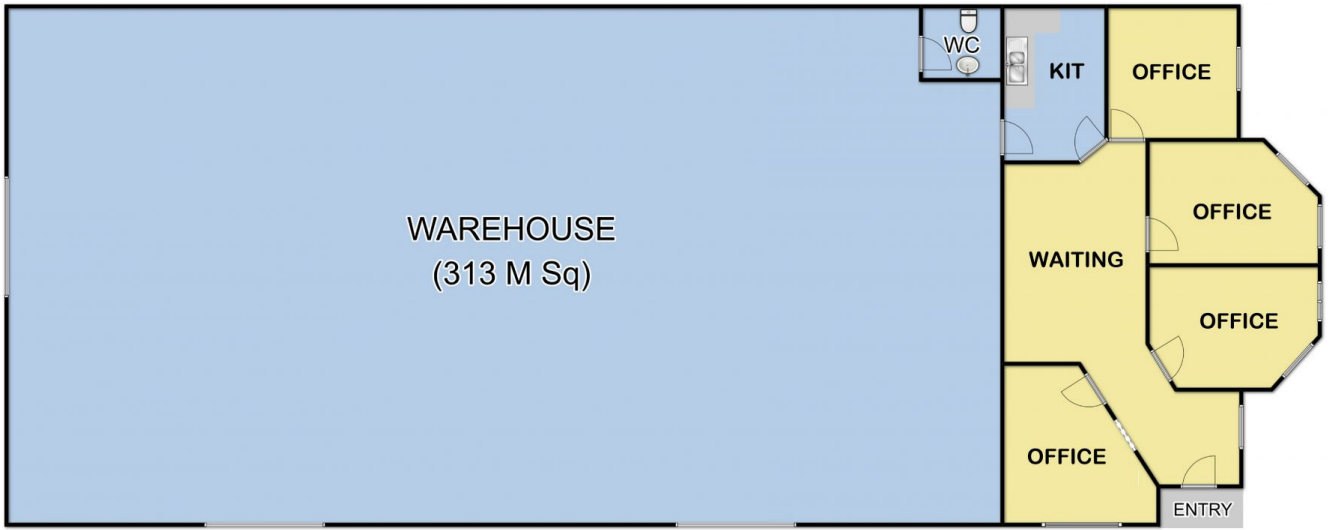

Fixtures & Fittings are for display purposes only. Measurements Approx. Not to Scale.  
Produced by [Open2view.com.au](http://Open2view.com.au)